

PRODUCT DATA SHEET

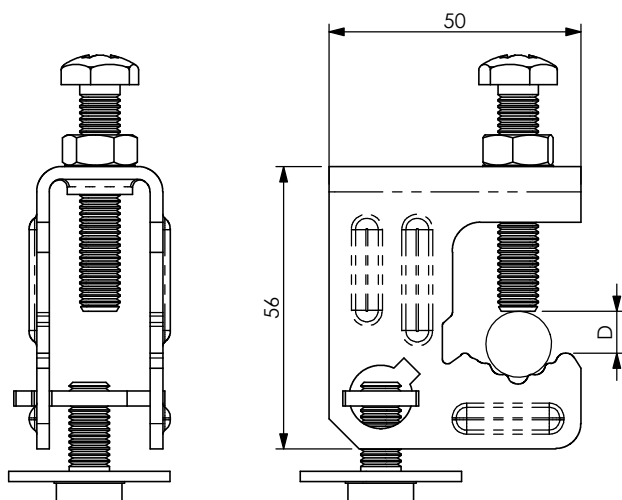

A) SPECIFICATIONS

- 1 Stainless steel VEI 8x45 screw
- 2 Stainless steel bow MBM 8
- 3 Stainless steel elastic washer REI 8
- 4 Stainless steel exagonal nut DAI 8
- 5 Stainless steel washer RPI 8/32

B) RESISTANCE TESTS

UV Test BS-ISO 105-B06
Vibration test conforming to UNI 60068-2-6

C) PACKAGING INFORMATION

Packing in boxes.
Label indicating:
product code, article, quantity,
production batch,
FIMO logo and figure.
(Customer code on request).

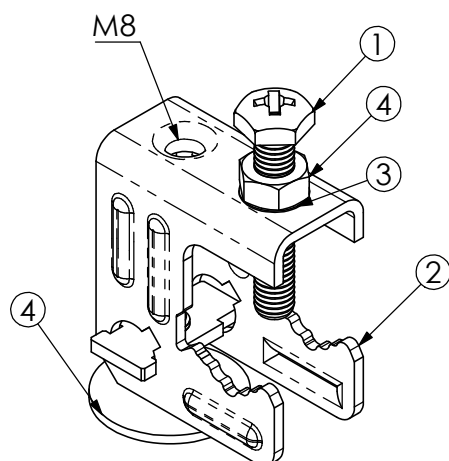

D) MOUNTING INSTRUCTIONS

On request



code	6115230125
article	MBM/8

20	0.1549kg.

RI	DATE	DR	DATE	AP	Description: MBM/8=multidirectional clamp 8-25
02					
01					
00	16/09/15	G.S.	16/09/15	A.V.	
1 ST EMISSION					
					Use: Multidirectional clamps, consisting of a stainless steel bow equipped with a M8 screw, allows hooking to various structures. By using M8 screw + a second hole inserted in a pivot pin other objects can be mounted and orientated.

FI.MO.TEC. S.p.a. reserves the right to modify the technical specifications without prior notice, according to the technical progress
Copyright FI.MO.TEC. S.p.a. All rights reserved.